

**Save these safety rules for future use.**

1. This tool will become quite warm during use. This is normal and does not indicate a problem.
2. The glue gun should be unplugged after use or if it will not be used within 2-hour period. The adhesive can be stored in the unheated gun and re-melted by heating up.
3. If you accidentally touch the molten hot glue, immediately immerse the affected area in cold water and call a doctor.
4. Some materials are heat-sensitive and can be damaged by the hot nozzle or even the hot glue. Whenever possible, test a piece of scrap material or a hidden portion of the object being repaired

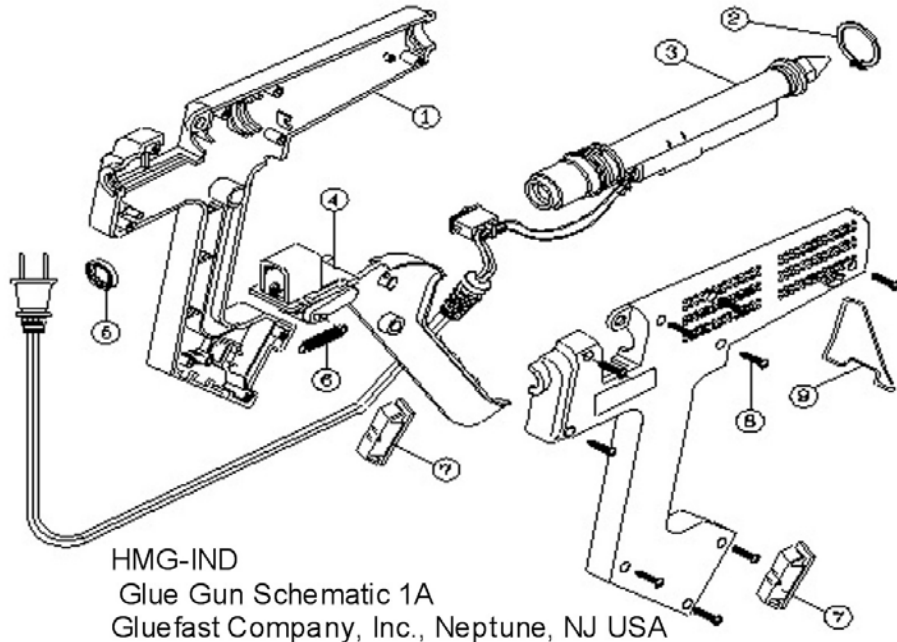

HMG-IND  
Glue Gun Schematic 1A  
Gluefast Company, Inc., Neptune, NJ USA

No.	Parts No.
1	IND-2333010
2	IND-9004006
3	IND-23-30500
4	IND-2333041A
5	IND-2114031-G
6	IND-2554020
7	IND-2333020-B
8	IND-9003003
9	IND-2332040



## *Operating Instructions* *Professional - Industrial Duty* **Model HMG-IND**

**READ SAFETY RULES AND INSTRUCTIONS CAREFULLY!**

**WARNING:**

1. **When using this hot melt glue gun, always follow basic safety precautions. This will reduce the possibility of accidental injury due to burns or electrical shock.**
2. **Always wear safety glasses and protective gloves and clothing. Long sleeve shirts and pants are recommended.**
3. **Use standard 1/2" glue sticks. Do not pull sticks out of glue gun!**

The Gluefast Company, Inc.

3535 Route 66, Building 1, Neptune, NJ 07753

Phone: 800-242-7318 / Fax: 732-918-4646

E-mail: [info@gluefast.com](mailto:info@gluefast.com) / Web Site: [www.gluefast.com](http://www.gluefast.com)

## **Read all Safety Instructions:**

- **Work area.** This tool was designed to be used on a clean, dry work surface. Excessive dust and dirt may reduce the lifetime of this tool. Do not use in wet or damp locations. Your work areas should keep well light.
- **This tool is recommended for indoor use only.** Do not use outdoors.
- **Keep children away.** Small children should be kept away from work area. Accidental contact with tool or extension cord should be avoided.
- **Glue gun storage.** After use, allow glue gun to cool completely prior to storage. When not in use, the glue gun should be stored in dry and secure location out of the reach of children.
- **Electrical cord precautions.** Do not carry the tool by the cord or yank to disconnect from the receptacle. Keep the cord away from the nozzle or other high heat sources. Periodically inspect the electrical cord for any sign of wear or damage.
- **Disconnect electrical power.** When not in use, before servicing, and when changing. Do not yank on cord to unplug from electrical receptacle.
- **Stay alert.** Pay attention to your work. Beware of any dripping hot glue from your project. Use common sense. Do not operate this gun when you are tired. Do not operate under the influence of alcohol or other drugs that may impair your physical abilities.
- **Do not touch the heated nozzle of the glue gun or the hot adhesive.** The operating temperature of this tool is 380°F(193°C).
- **Use recommended accessories.** For best results use Gluefast hot melt glue sticks.. Putting other materials than recommended may result in accidental injury and permanent damage to the glue gun. For example: do not attempt to melt crayons or candles.
- **Never use the tool if it is damaged in any way. Hot melt adhesives are not a replacement for structural fasteners.**
- **Hot melt glue should not be used for projects that will be exposed to extreme heat.** Some adhesive used with this glue gun can soften at about 140 °F.
- Do not attempt to remove unused portion of a glue stick from the tool.
- Do not expose the glue gun to extreme changes in temperature during or directly after use. Never immerse glue gun in water or other liquids to speed cooling process. Allow the gun to air cool only.
- Children should not use this glue gun.
- Do not leave the glue gun unattended while plugged in or in a hot condition.
- Do not use in an explosive atmosphere or where explosion proof devices are required.
- If the supply cord is damaged, the manufacturer or its service agent or a similar qualified person must replace it in order to avoid a hazard.

## **Operation**

1. Make certain that the metal stand is in place to properly support the glue gun.
2. Plug the glue gun into any AC outlet with required specification. Turn on the switch on the glue gun unit. The red light is indicates that the glue gun is powered.
3. Allow 3-5 minutes for the glue gun to heat up. Insert a stick with the dia. of 11mm, (standard ½” size) into the back of the glue gun. (You may also use glue sticks of 4”, 10”, and 12”in length)
4. Wait until the glue gun is completely heated, then slowly feeding the trigger until the hot melt glue is flowing from the nozzle. Release the trigger to stop the glue from flowing out.

## **Preventive Maintenance**

1. To prevent the clogging of the glue gun, keep feeding mechanism and melt chamber free from dirt and other foreign debris. Store unused glue sticks in a clean environment.
2. Do not pull glue stick out from the back of the glue gun. The feed mechanism may be damaged or impaired. If you want to change the glue stick, cut off the protruding end and feed the remainder through with the new type of glue.
3. **Do not lay heated gun on its side.** Keep the heated gun in an upright position, on the metal stand or workbench, with nozzle pointed down.
4. If melted glue has escaped from the melt chamber entrance and is interfering with the feed mechanism, allow gun to cool, and gently remove the obstructing glue.
5. Replaced the nozzle if glue drips excessively. Do not attempt to change nozzle when the glue gun is cold. To change, the gun must be heated until the glue is softened enough to remove the nozzle (about 1 minute). Use gloves and remove the old nozzle with a wrench. Flush glue through the gun to clean out the melting chamber. Replace with a new nozzle. Tighten only until snug. *Do not over tighten!*
6. Keep outside of glue gun clean.

**Six Month limited warranty from date of purchase.**

Contact Gluefast for details.

HMG-IND 2004/11